



2022 PARK CITY AREA SHOWCASE *of* HOMES



AUGUST 26-28 AND SEPTEMBER 2-5

FRIDAYS: 2PM-8PM • SATURDAYS, SUNDAYS AND LABOR DAY MONDAY: 10AM-6PM

PCShowcaseOfHomes.com

2021 People's Choice Winner
Ezra Lee Design+Build
ezralee.com



PRESENTED BY:

ZIONS BANK®

WE HAVEN'T FORGOTTEN WHO KEEPS US IN BUSINESS®

SPONSORED BY:





Photography: Doug Burke

Voted Park City's Best General Contractor

PERSONABLE | ACCOUNTABLE | EXPERIENCED

New Construction | Design-Build | Commercial | Remodel

bdogbuilders.com | 435-649-5252 | email us at office@bdogbuilders.com

LISTEN TO HEATHER OSMOND HOST THE  REAL ESTATE SHOW EVERY SATURDAY FROM 11AM-12PM

OSMOND  DESIGNS

151 E. STATE STREET, LEHI • 801-766-6448
1660 N. STATE STREET, OREM • 801-225-2555

OSMONDDESIGNS.COM



BEST OF UTAH VALLEY
WINNER
FURNITURE HOME
DECOR INTERIOR DESIGN



2022 BEST OF HOUZZ
WINNER
INTERIOR DESIGN
CUSTOMER SERVICE



2022 BEST OF STATE
WINNER
INTERIOR DESIGN
HOME DECOR FURNITURE



"These are
a few of my
favorite things!"

-Heather Osmond



Featured In: **Forbes** **ELLE DECOR** **AD** **THE WALL STREET JOURNAL** **Style-Design** **food** **Good Things** **hat** **KJZZ 14** **IM** **KSL NEWSRADIO**



Serving all of Utah, and we also ship products to Arizona, Idaho, Wyoming, Montana, and California!



HELPING YOU OPEN NEW DOORS

- Entry systems • Pivot doors
- Interior doors • Custom millwork
- Hardware

HARDWARE

- Entrysets • Barn Door Hardware
- Pocket Door Hardware
- Interior Door Hardware

2284 South Spring Hollow Road
Kamas, UT 84036
435.513.1093
FRONTIERWOODWORKS.ORG



elume

DISTINCTIVE LIGHTING

AALTO PENDANT BY
HAMMERTON™

HANDCRAFTED IN UTAH
IN ARTISAN BLOWN GLASS
WITH INTEGRATED LED



24th Annual
ARTS
AWARDS
WINNER



25th Annual
ARTS
AWARDS
WINNER



29th Annual
ARTS
AWARDS
WINNER

Park City, Utah - Showroom
3156 Quarry Road Unit A
Open M - F 10 - 5 and by Appointment
(435) 647-2997 | www.elumepc.com

Stunning Tile Style, Made in America

Crossville makes and stocks exceptional tile surfaces worthy of your unique design vision right here in the USA. Don't delay your dream project! Visit a Crossville Studios showroom nearby to experience our gorgeous floor and wall tiles and porcelain countertops firsthand.

Featured - **Owen Stone** porcelain tile collection, responsibly made in Crossville, Tennessee

SLC Tile
3711 South 300 West
Salt Lake City, UT 84115
801.262.1717

SLC Slab Gallery
2885 South 300 West
Salt Lake City, UT 84115
801.433.1717

American Fork
938 South 500 East
American Fork, UT 84003
801.426.8686

Ogden
3004 South 1900 West
Ogden, UT 84401
801.436.1717

St. George
440 West 200 North
St. George, UT 84770
435.628.3700

Crossville
Studios

CONTEMPO
Tile - Stone - Slab

TIMELESS



801-930-9499
WALKERHOMEDESIGN.COM

WALKER
HOME DESIGN

YOUR WORLD CLASS HOUSE PLAN

2021 Park City Showcase of Homes Peoples Choice Award Winner

Ezra Lee Design+Build

*an Architecture, Construction,
+ Interior Design Firm.*

*"This ski and golf house nestles into the
Promontory hillside, and captures panoramic views
of the ski resorts, and the surrounding golf course."*





The Design

With an aggressive natural grade, the goal was to minimize both impact & visibility of the building from neighboring lots while maximizing space & views.

The unique firm has **architecture, construction, interior design, and furniture + décor** under one roof. This ecosystem gives them the ability to look at a raw piece of land from all perspectives to identify the priorities and maintain the same vision from concept to a fully completed project.

Signal Hill is a custom home in Park City's Promontory community that was awarded the **People's Choice Award in the 2021 Park City Showcase of Homes**.

It is an iconic Park City ski and golf cabin and presents a novel take on the family ski and golf vacation experience. Signal Hill embraces the clean lines of modern architecture; however, it achieves a certain timeless quality that transcends the trends of the year it was built.

This ski and golf house nestles into the Promontory hillside, and captures panoramic views of the ski resorts, and the surrounding golf course. Intended as a ski chalet, four equal bedroom suites on level two sit above a large gathering area with dramatic views and an expansive deck system that allows for indoor/outdoor living fit for all four seasons.

The dynamic team at Ezra Lee Design+Build collaboratively conceptualized and executed a project that has become an icon in the area.

ezralee.com

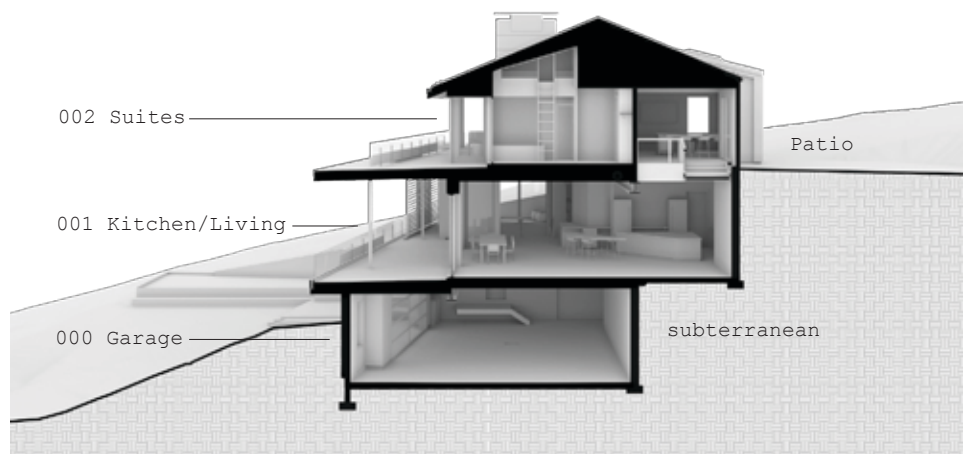



Ahhhhh... Oxygen!™

Imagine how you'll feel tomorrow after sleeping in your oxygenated room tonight.™

Altitude Control Technology's award-winning oxygenation system lowers your effective altitude by as much as 7,000 feet.

Eliminate the insomnia, fatigue, and headaches associated with altitude and instead wake refreshed and ready to enjoy your mountain home.

Let ACT upgrade your room's oxygen content. Call today!



The safest, most effective oxygenation systems on the planet.™

MORE INFORMATION



ACT
ALTITUDE CONTROL TECHNOLOGY

For more information about what oxygenating your home can do for you, call:
(435) 222.7437 or visit AltitudeControl.com

First year service included with code PCSHOWCASE22
Interested in becoming an ACT Partner? Contact partners@altitudecontrol.com



ACT is the world leader in altitude simulation. Clients include: Harvard Medical School · University of Colorado School of Medicine · Federal Aviation Administration · U.S. Naval Air Systems Command · Olympic Training Centers in 14 countries · More than 50 medical schools and universities on five continents

CREATIONS WEST

Even The Best Dreams Need A Plan!

CUSTOM & STOCK HOUSE PLANS
2D & 3D DESIGNS
ADDITION & REMODEL PLANS
CREATIONSWEST.COM
801-525-6700



HELM

Furnishing Utah's Finest Homes

You hold your home to a high standard. You give it your time, your attention, and a whole lot of love, and your home loves you right back. It offers a place to spend quiet moments, host large gatherings, and gives you an unmistakable sense of belonging.

Your home is all your own, right down to the very last detail.

Let Helm help you put the finishing touches on your home. Our curated collection of high-end furniture, including Baker, Century, Bernhardt, Hickory Chair, Lexington, Massoud, and more, is handpicked by our team of interior designers, so you can find your unique style and transform your space into a place you can be proud to call home.

STOP BY OUR 30,000 SQUARE-FOOT SHOWROOM
OR CALL TO SCHEDULE A PRIVATE WALKTHROUGH.



5253 S STATE ST. MURRAY, UT 84107

(801) 263-1292 | HELMHOME.COM

Designed for the great indoors.

**HOMEOWNERS RATE PELLA WINDOWS AND DOORS #1 FOR HIGHEST QUALITY.*
FIND YOURS AT PELLA WINDOWS AND DOORS OF UTAH.**

**VISIT YOUR LOCAL PELLA SHOWROOM:
PARK CITY | 3126 QUARRY RD UNIT 4-C
CALL: 801-566-4131**



*Study of homeowner perceptions of leading national brands. Study commissioned by Pella, 2021. ©2022 Pella Corporation.



**PERFECTED
BY PELLA.**



KRISTINA LAWRENCE

INTERIOR DESIGN

Your Home is a Reflection of You

By taking on only a handful of projects each year - both big and small, and in a variety of styles – we are able to focus on each client's unique personality and lifestyle, guiding your project from concept to completion in a way that reflects who you are and who you are becoming.

Find us in Park City, Utah, at www.klawrencedesign.com and on  **houzz**





PARK CITY BLIND
AND DESIGN

BLINDS | SHADES | DRAPES | SHUTTERS | UPHOLSTERY | MOTORIZATION

435.649.9665

DESIGNER FLAIR HUNTER DESIGN | PHOTOGRAPHER REBEKAH WESTOVER



VAN SICKLE

DESIGN & DRAFTING



Premier, High-End Design

for custom homes that are one of a kind

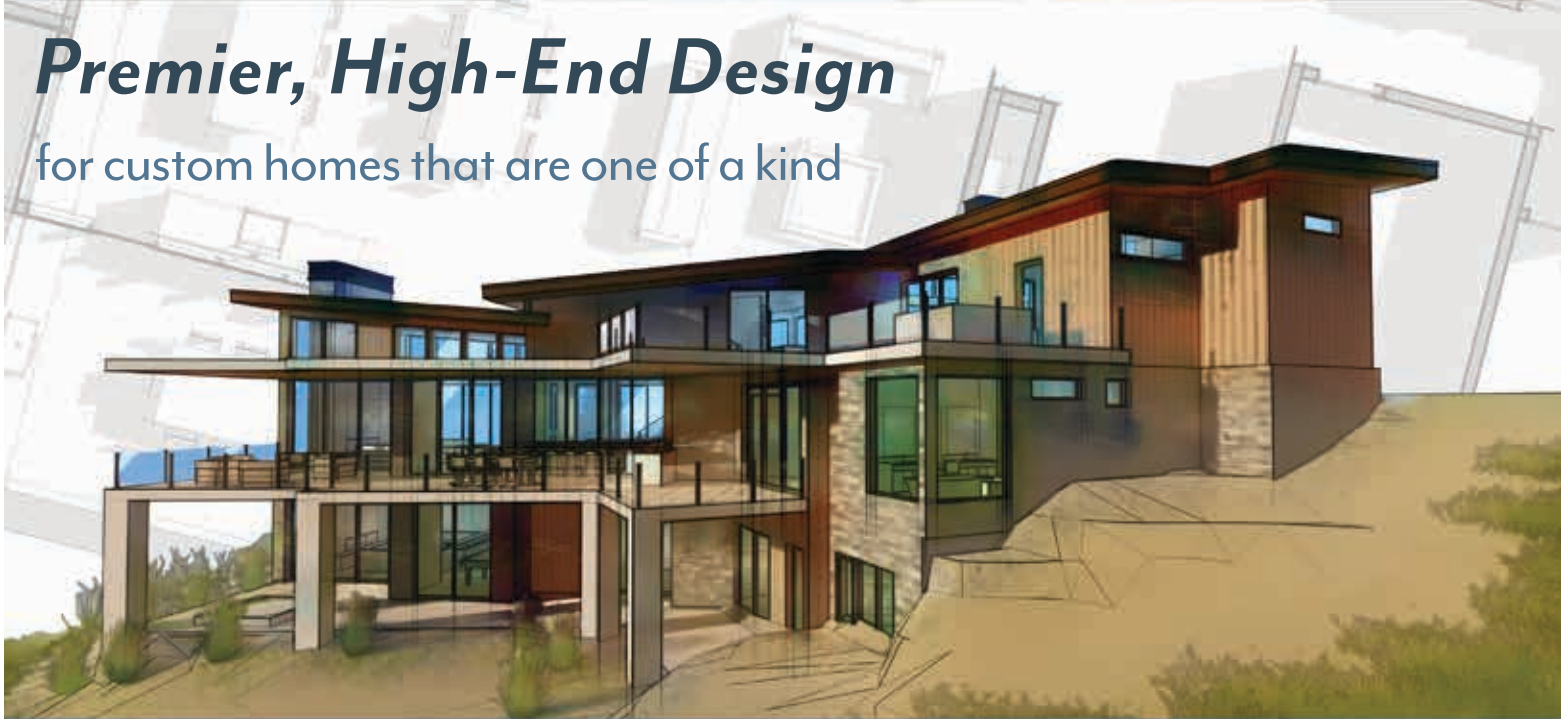

786 Division Street #102

Park City, Utah 84098

VanSickleDesignandDrafting.com

Bill@VanSickleDesigned.com

801.694.9683





HABITATIONS

RESIDENTIAL DESIGN GROUP

CUSTOM HOME DESIGN • SITE CONSULTING

(801) 476-1860

HABITATIONSRDG.COM



Eleven time "Best of houzz" winner!



Home is Your World

These days, your home is also your workplace, classroom, theater, restaurant and gym. Custom window treatments from Sunburst Shutters & Window Fashions will transform your home beautifully for everything you do. For over 40 years, Sunburst has helped customers make their homes more stunning and functional.

We don't just do it right... we do it better.™

Sunburst
SHUTTERS &
Window Fashions

801-756-0065



SunburstShuttersUtah.com
71 South 1380 West, Suite 2, London





PARK CITY, UTAH

4490 Forestdale Dr.

Suite 203

M-F, 9am - 5pm

435-565-6115

MIDVALE, UTAH

7139 South 700 West

M-F, 8am - 5pm

801-563-3343

SHOWERS • MIRRORS •
DECORATIVE HARDWARE
CUSTOM FRAMING • STORE
FRONT • GLASS RAIL • & MORE

tannerglass.com





Photo by Ezra Lee Design+Build

2022 PARK CITY AREA **SHOWCASE of HOMES**

AUGUST 26-28 **AND**
 SEPTEMBER 2-5

Both Fridays: 2 p.m. to 8 p.m.
 Both Saturdays, Sundays, and
 Labor Day Monday: 10 a.m. to 6 p.m.
 (see pullout map)

NOTE: Park City Area Home Builders Association
 takes no responsibility for any Showcase of Homes
 participants that are not open for public viewing
 during Showcase of Homes dates. All square footages
 listed are approximate.



Guide to the Homes.....	24
Ticket Info	28
Showcase of Homes App.....	28
Showcase of Homes Sponsors.....	32
Welcome to the 2022 Showcase of Homes.....	36
PCAHBA Board of Directors/Officers.....	40
Frequently Asked Questions.....	44
Showcase of Homes	48

Cover photograph by Ezra Lee Design+Build / ezralee.com

Home Renderings by Jim Staker

Showcase Home Photography by

Real Estate Video Professionals & Snap Sale

Headshots by Impact Photography

Park City Area Home Builders Association

P.O. Box 980850

Park City, UT 84098

PHONE 435-645-9363

info@pcahba.com • www.pcahba.com

Published in partnership with:

 **DeseretNews.**

55 N. 300 W.
 Salt Lake City, UT 84101
 Office: 801-204-6300
 www.deseret.com

PROJECT TEAM

Megan Donio, Publications Manager
 Serina Nielson, Graphic Design

ADVERTISING

Sally Steed, Director of Advertising

ACCOUNT MANAGERS

Pam Barnett
 Suzanne Benitez
 Samantha Campbell



Quality for Life



WWW.LANDMARKSWEST.COM





McEwan
CUSTOM HOMES

THE DIFFERENCE IS IN THE DETAILS

Five time Utah Valley Parade of Homes winner McEwan Custom Homes specializes in building high end luxury homes. We are committed to fostering strong, lasting relationships with our clients that result in an exceptional building experience.

mcewancustomhomes.com

GUIDE TO HOMES

SECOND CHANCE TO TOUR



Page #48

Ezra Lee Design+Build
3526 Westview Trail
Promontory, Park City



1

Page #50

Killowen Construction
7509 N. Bugle Trail
Promontory, Park City



2

Page #52

Hamlet Homes
1242 Gamble Oak Way
Silver Creek Village, Park City



3

Page #54

Greenlaw Construction
1458 W. Orion Way
SkyRidge Estates, Heber City



4

Page #56

JC Luxury Homes
1522 W. Ursa Way
SkyRidge Estates, Heber City



5

Page #58

Mayflower Luxury Homes
1461 W. Ursa Way
SkyRidge Estates, Heber City



6

Page #60

H2 Homes
485 W. Peace Tree Trail
Deer Vista, Kamas



7

Page #62

Gough Contracting
186 W. Lazy Acres Lane
Lazy Acres Estates, Kamas



8

Page #64

Joe Witt Construction
339 E. Deer Ridge Drive
Deer Ridge Estates, Midway



9

Page #66

Elements Custom Homes
1129 W. Lime Canyon Way
Lime Canyon, Midway



10

Page #68

Ivory Homes
427 S. 1850 E.
Beaufontaine, Heber City

2 WAYS TO ENJOY

1

To participate in the traditional walk-through tour:

- Put on clean socks and wear comfortable, easy to remove shoes.
- Load your ticket onto your smartphone and have it ready to present at each home.
- Download the app, view the map, start at any home and visit in any order you wish.
- Get inspired and enjoy!

2

To participate in the virtual tour:

- Go to www.PCShowcaseOfHomes.com
- Select Virtual Showcase
- Enter your virtual passcode found on your ticket
- View the homes in any order, as many times as you wish.
- Get inspired and enjoy!

MINKY COUTURE

BEST.GIFT.EVER.



Minky[®]
Couture

DESIGNER BLANKETS

801.682.8422 • WWW.MINKYCOUTURE.COM

LAYTON • DRAPER • ST. GEORGE • OREM • SUGAR HOUSE • SOUTH OGDEN

VISIT OUR WEBSITE AND RECEIVE 45% OFF USE CODE: **PC45**

Special Prices above are not valid with any other offer and may not be combined. Some exclusions may apply.

The best in home fragrance.



844 South 800 West Ste 214
Pleasant Grove, UT 84062
844-446-6654
www.mojipproducts.com

mojilife[™]
HOME & CAR FRAGRANCE
Enjoy Every Moment[™]

Tickets available at PCShowcaseOfHomes.com \$20 (all ages)

See homes in-person or sit back and tour them virtually from the comfort of your own home, these magnificent homes will not disappoint!

- Tickets will NOT be sold at any of the homes during the Showcase.
- Tickets are valid for both the traditional walk-through and the virtual Showcase.
- Each ticket is good for all dates and times during the Showcase. Each ticket is good for one visit per home plus re-entry to two homes of your choice

Download the Showcase app "Park City Showcase."



TRACK HOMES VISITED



HOME & BUILDER INFO



HBA MEMBERSHIP
DIRECTORY



TURN-BY-TURN
DIRECTIONS TO
EVERY HOUSE!



BARCLAY BUTERA
INTERIORS

LUXURY MODELS
RESIDENTIAL
DEVELOPMENTS

PLEASE CONTACT US FOR
COMPLETE DESIGN SERVICES

255 HEBER AVENUE

PARK CITY

435.649.5540

WWW.BARCLAYBUTERA.COM



KIP SLAUGH & ASSOCIATES, INC

Concrete Specialists

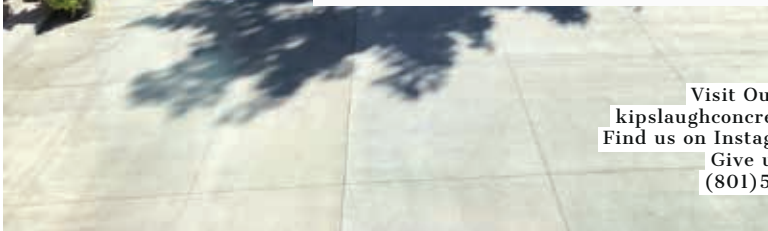

Visit Our Website
kipslaughconcretespecialists.com
Find us on Instagram and Facebook
Give us a Call
(801) 573-3821



INDEPENDENT & FAMILY-OWNED WITH **30 YEARS** OF EXPERIENCE
UTAH'S PREMIER CLOSET & GARAGE DESIGNERS
theclosetbutler.com | 1272 W Sportsplex Dr. Kaysville, UT | 801.728.0747

SOME CALL IT “FLYOVER.”
WE {*blissfully*} CALL IT HOME.



Night skies are darker in the mountains of the West. Our star-kissed towns and the surrounding pristine environments inspire us. And our homes connect us with our families, our communities, and nature.

Behind all great mountain homes are compelling stories. As the go-to source for the best in architecture, construction, and design, *Western Home Journal* loves to tell them, but shh... let others continue to fly over.

INSPIRING LOCATIONS | ELEVATED SPACES

BEND | BOZEMAN/BIG SKY
FLATHEAD VALLEY | JACKSON HOLE
PARK CITY | SUN VALLEY

WESTERNHOMEJOURNAL.COM



Presenting Sponsor

ZIONS BANK®

WE HAVEN'T FORGOTTEN WHO KEEPS US IN BUSINESS®

Rob Jibson, Cory Holmes, and Kammra Montgomery have served the banking & financial services industry in Summit and Wasatch Counties for close to three decades. They have over 50 years of combined mortgage and construction financing experience. The single most satisfying element of working in this industry for each of them are the relationships that they've built with their clients and business partners after a job well done.

Zions Bank Home Mortgage & Construction Group offers a wide variety of lending products. The phrase "We haven't forgotten who keeps us in business", is evident in our unique portfolio products that have been created to meet our client's unique and individual needs. In addition to our flagship, 1xClose Construction loan program, Zions Bank Mortgage also offers condotel financing, long-term interest locks (up to nine months for new construction purchase loans), no maximum loan amounts, competitive interest rates, relationship pricing, asset dissipation programs, and cash-flow and tax analysis for the self-employed & high net-worth clients. There's a reason we've been named Best in State for two of the last three years. It's time to give experience a try!

For questions or inquiries contact:

Rob Jibson @ (435) 658-5311 | NMLS# 532164

Cory Holmes @ (435) 671-3580 | NMLS# 494844

Kammra Montgomery @ (435) 671-8571 | NMLS# 293439

Supporting Sponsors



Dominion Energy®

ThermWise.com

Dominion Energy provides safe, reliable natural gas service to more than 1 million customers in Utah, Wyoming and Idaho. Since 2007, Dominion Energy's ThermWise program has helped homes, businesses and builders use energy more wisely. The program offers Home Energy Plans as well as rebates for energy-efficient appliances and weatherization improvements. Remember: "If you conserve, you can save!"



Kip Slauch and Associates, Inc. is a locally based, family run concrete construction firm. We have been doing work in the intermountain area for over 30 years. Our office is located in the Salt Lake Valley, and our construction staging yard is in Kamas. For several years, we have been a predominant contractor throughout Park City, Wasatch and Summit County areas but we also do work in Salt Lake Valley as well as other areas in Utah and throughout many of the intermountain states. We are a full-service concrete contractor with a complete inventory of Symons forms. We are able to do all types of footings, foundations, site work, and flat work, including colored and stamped pattern concrete as well as different finishes. We are also able to do stained colorings and sealers. Contact Kip Slauch at (801) 573-3821 for more information or an estimate on your next project.



Minky Couture was established in 2009. Owner, Sandi Sumner Hendry, started by giving fun, unique, and functional gifts to friends and family members. The blankets she gave were an instant hit. Universally loved and used daily, she decided to do a little more research on these soft, cuddly blankets. In doing so, she discovered the wonderful world of minky fabric. Minky Couture is now a household name in the state of Utah with 6 retail store and a wonderful e-commerce presence.



MojiLife has created the industry's best home fragrance device, the AirMoj! Experience home fragrance that is safe for your family, simple to use, and also a smart device that can be controlled from your smartphone. With a wide variety of popular fragrances and essential oils, there is something to fit every style. You can also take any of our fragrances and essential oils on-the-go with our innovative CarMoj! device. Create a welcoming environment in your home and car with MojiLife!



MLD has five showrooms that offer the latest appliances, plumbing, and hardware for your home or business. Our showrooms are live and installed for your testing, so you can try before you buy! Through an out-of-the-ordinary showroom experience, extraordinary adventures, and beyond ordinary services, we invite you to our showroom to meet with our team and discover why working with us is easier and more enjoyable.

Question the ordinary at MLD • UTAH | IDAHO | WYOMING • WWW.MLD.COM



At Peppertree we pride ourselves on our service from start to finish. Our designers take your thoughts, ideas and dreams and bring them to reality. Each piece is built to order and designed specifically for each client. Contact us about your project today and let us show you our commitment to delivering an unforgettable experience. Founded in 1986, Peppertree Kitchen & Bath has become one of the best-known cabinet manufacturers in Utah.

Visit one of our Showrooms or call to talk to one of our Designers.
West Jordan, Utah 7940 S. 1300 W. 801-565-1654
Jackson, Wyoming 485 W. Broadway 801-565-1654

Additional Sponsors:



GHIGAU
CONSTRUCTION





YOUR LIFE CHANGES, YOUR HOME SHOULD CHANGE WITH IT.

We understand that building your dream home is not one-size-fits-all. That is why at Zions Bank we offer a variety of home construction loans* to help you achieve the results as unique as you are.

**Best of State
Utah 2022**



Mortgage Banking

Cory J. Holmes
NMLS #494844
cory.holmes@zionsbancorp.com
435-709-3264

Rob Jibson
NMLS #532164
rob.jibson@zionsbank.com
435-658-5311

Kammra Montgomery
NMLS#293439
kammra.montgomery@zionsbank.com
435-671-8571

ZIONS BANK®

*Subject to credit approval. Terms and conditions apply. Equal Housing Lender  Zions Bank NMLS #467014.
A division of Zions Bancorporation, N.A. Member FDIC



SCAN ME

Custom Home Design



801 298 2240

South Jordan

For Information Please Contact

Brian Preece, Director of City Commerce

801-254-3742; bpreece@sjc.utah.gov www.sjc.utah.gov

"Best Places to Live"—Money Magazine



Harvest Village



Shopping—Costco, Wal-Mart, Sportsman's Warehouse, VASA, Restaurants, Financial, Medical

Mulligans Golf & Games



Driving Range, Golf Course, Mini-Golf, Batting Cages

FrontRunner TOD/ SoJo Station



High Speed Commuter Rail/TOD — Class A Office, Apartments, Service Retail, Full Service Hotels (Existing & Under Construction)

Daybreak



Mixed Use—Commerce Park, Residential, Senior Living, Retail— SoDa Row & Trail Crossing Shopping Center

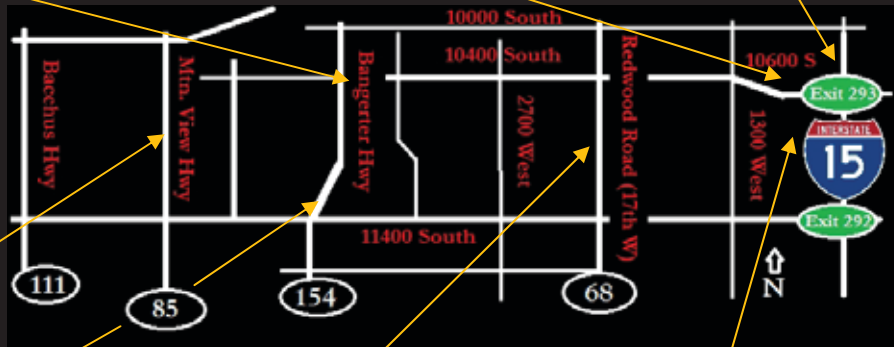

20 Minutes from Downtown Salt Lake City and the Salt Lake International Airport

The District



Lifestyle Center—Megaplex 20 Theatre, Restaurants, Shopping, Residential

Redwood Road / SJ Parkway



Shopping — Towne Center, Restaurants, Residential, Library, City Offices Farmers Market -Saturdays 8am- 2pm

RiverPark Corporate Center



Class A Office Space—Restaurants, Fitness Center, Jordan River Trail Access

Welcome to the 2022 Park City Area Showcase of Homes

On behalf of the Park City Area Home Builder's Association, we'd like to welcome you to the 2022 Park City Area Showcase of Homes!

Once again, we are bringing you beautiful homes located across the scenic Wasatch Back from Park City to Midway, with many scenic stops on the way.

These homes represent the work and passion of the dedicated homebuilders, interior designers and craftspeople who make up our association. We are sure you will find much to look at, and many ideas to take home and implement in your own projects. And we hope you'll find a builder or a trade representative who can help you turn your dream into reality.

As a Home Builders Association, we represent the interests of everyone in the home construction community in our area, from Contractors, Subcontractors and Interior Designers to Excavators and Landscape Designers. One of our major roles as an organization is to be a powerful advocate for our industry at local, state and national government levels. In addition, our members develop strong bonds by working together on a broad range of service projects in our local communities, as well as social events.

Building large and complex homes in the current global environment is not an easy task. We are still subject to the whims of supply chain issues and labor shortages. We've seen costs soar and budgets shrink. But we think that you will agree, looking at this year's homes, that our members have yet again pulled off some miracles of design and project management in some very challenging circumstances.

This year, we decided to do something a little different. We felt that you'd enjoy another opportunity to take a look at the winner of last year's People's Choice Award. We know that sometimes, getting around every home in the Showcase can be challenging, and it's disappointing to miss out on a really good one! Ezra Lee Design+Build has graciously opened their spectacular home in Promontory for a second time, and we hope you enjoy it.

We are again offering our Virtual Showcase online to ticket holders who can't get to the Showcase in person or want to take a closer look at the individual homes. Access is available with the purchase of a regular Showcase ticket.

Of course, none of this could happen without our amazing sponsors. We'd like to thank Zions Bank, our Presenting Sponsor again this year, Dominion Energy/Thermwise.com, Kip Slauch & Associates, Minky Couture, MojiLife, MLD, Peppertree Kitchen & Bath, Altitude Control Technology, Ghigau Construction, ShadeCo, and Honey Bucket for providing their invaluable support to the Showcase, and to the Park City Area Home Builders Association throughout the rest of the year.

Thank you for coming. We hope you enjoy your visit to our beautiful mountain communities. And please, don't forget to vote for your favorite home after your Showcase visit so we can award our coveted People's Choice Award to the home you most enjoyed! Vote at www.PCShowcaseofHomes.com

2022 Park City Area HBA
Showcase of Homes Committee



PARK CITY AREA
HOME BUILDERS ASSOCIATION

Thank you to our
generous 2022
sponsors for their
continuous support

MONTHLY MEMBERSHIP SOCIALS

CET & Associates
Delta Stone Products
Hamlet Homes
NERVE Park City
Schluter Systems
ShadeCo
Silver Mountain Glass
Metro Tile
MLD - Mountain Land Design
Zions Bank

NEW MEMBER BREAKFAST

Anvil Appliances / Anvil Cabinet & Mill
Roth Living

GOLF TOURNAMENT

Title Sponsor: Builders FirstSource
Drink Cart Sponsor: Kitchen & Bath Distinctions by Southwest Plumbing
Hole Sponsors:
A+ Elevators & Lifts
Audio Video Systems
Bedrosians Tile & Stone
Build Magazine
Delta Stone Products
Foremost Interiors
Hearth & Home Distributors of Utah
Honey Bucket
Kip Slauch & Associates
Laticrete
OrePac
SavATree
ShadeCo
Sierra Pacific Windows
Sound Capital
Tanner Glass & Hardware
Wattsmart Home / Rocky Mountain Power
Zions Bank

Be cozier at home. **And get money back.**

Building a new home?

Tell your builder you want energy-efficient appliances and rebates.

Doing home improvements?

Visit ThermWise.com to see what rebates are available for new appliances and home weatherization.

Where to begin?

Call 1-888-324-3221 to schedule your customized Home Energy Plan and learn how to save money now.



**Dominion
Energy®**

ThermWise.com

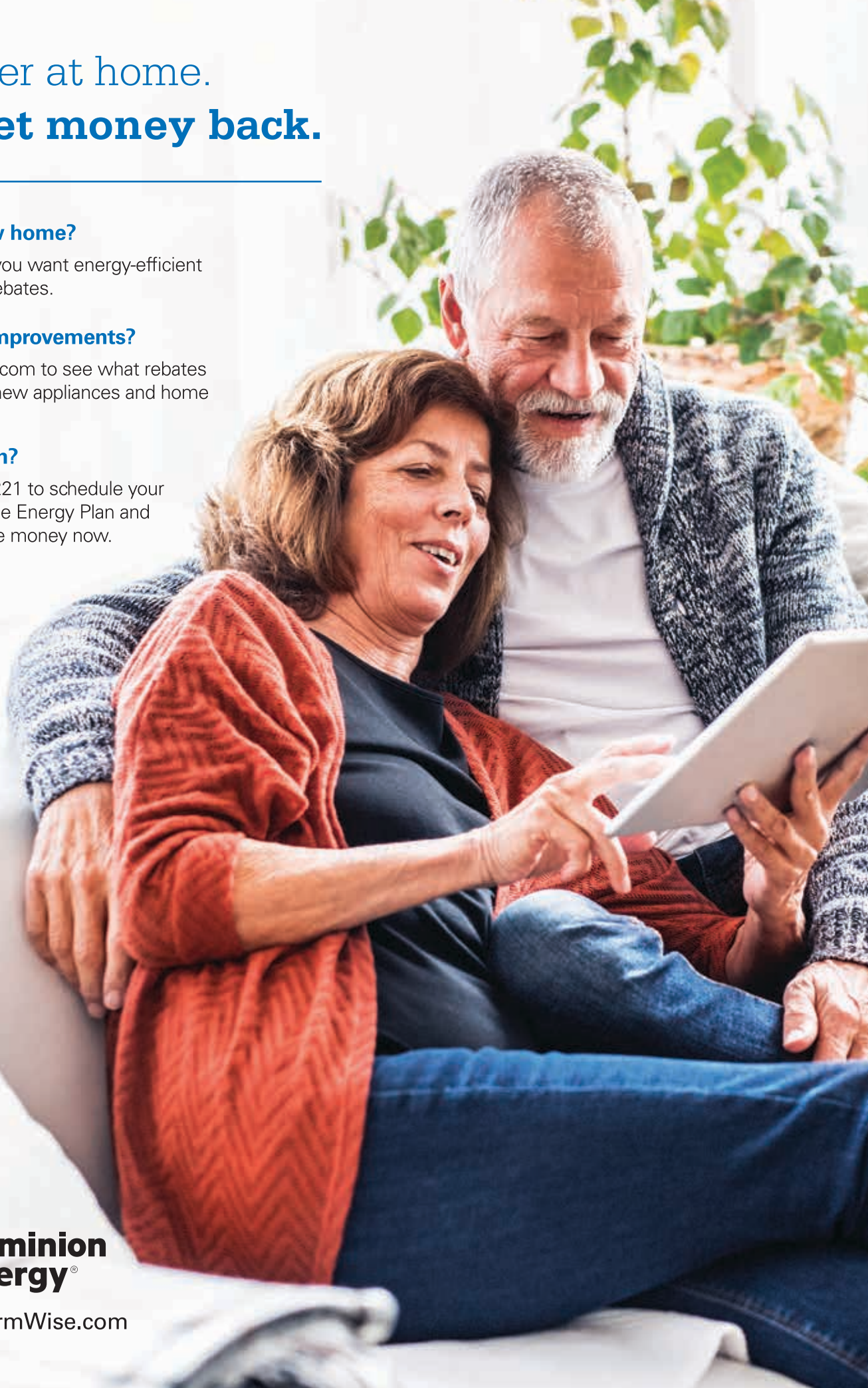



BLACK GRANITE COUNTERTOPS

801-467-4439

www.blackgranite.us

Let us bid your home!

UT DOPL#6394834-5501

KITCHENS

BATHROOMS

CUSTOM





STAKER PARSON

LANDSCAPE CENTERS

A CRH COMPANY



Shape your scape!

- TOPSOIL
- FLAGSTONE
- ROCK
- MULCH
- BARK
- ARTIFICIAL TURF
- PATIO PAVERS
- PLAYGROUND SAND
- GOLF SAND
- GRAVEL

**10 %
OFF**

****Bring this coupon in
for 10% off your purchase
of landscape products.**

Offer expires 10/31/2022

****Offer does NOT apply to delivery, concrete, or specialty products.**

Let Staker Parson Landscape Centers make your job easier by giving you no-hassle service and the best landscape products in Utah. We stock the biggest variety of sand and aggregate products, from colorful cobble to USGA approved golf course sand. But we don't confine ourselves to quality landscaping products — we also offer ready mix concrete, asphalt, paving and construction services. What can we do for you today?

BOARD OF DIRECTORS

PARK CITY AREA HOME BUILDERS ASSOCIATION MISSION STATEMENT

The Park City Area Home Builders Association is a nonprofit organization serving the surrounding areas of Summit, Wasatch and Duchesne counties. It is a member-driven, volunteer organization of builders and associates who are leaders in the building industry and who are stalwart in ensuring a better community and a brighter future for the areas in which they live and work.



Paul Montgomery
President
Montgomery
Construction
Management, LC



Jenn Lewis
First VP
Ghigau Construction



Jake Jorgenson
Second VP
Jorgenson Builders



Amanda Trickett
Associate VP
Closet Factory



Danny Moreno
Associate VP
Audio Video Systems



Steve Norr
Secretary
Peppertree Kitchen
& Bath



Rob Jibson
Treasurer
Zions Bank



Aaron Blanco
Builder Director
Modern Design
+ Build



Joe Witt
Builder Director
Joe Witt Construction



Rob Phelps
Builder Director
Hawkes Phelps Homes



Brandon Hicks
Associate Director
Magleby Construction



Tom Nafus
Associate Director
VELUX America



Sue Slaugh
Associate Director
Kip Slaugh & Associates



Alan Whetton
Associate Director
Anvil Appliances/
Anvil Cabinet & Mill



Alicia Ackerman
Executive Officer
PCAHA

BUILDER DIRECTOR NOT PICTURED

Keith Van Dyke
Riverwoods Construction & Design

UTAH HBA REPRESENTATIVES

Max Angle
Live Well Builders

Aaron Blanco
Modern Design + Build

Matt Russell
Russell & Co.

Kammra Montgomery

Zions Bank - Heber

Brandon Hicks
Magleby Construction

Jenn Lewis
Ghigau Construction

NAHB REPRESENTATIVES

Max Angle
Live Well Builders

Greg White
Interstate Brick

PAST PRESIDENTS

Pierrette Tierney
American Homes 4 Rent

Max Angle
Live Well Builders

Chris Quinton
Cameo Homes

Doug Jardine
Jardine Construction

Matt Russell
Russell & Co.

Joe Rametta
Rametta & Co

Preston Campbell
Go West Development

Garrett Strong
Tall Pines Construction

Todd Evans
Blackdog Builders

Jason A. Moore
Plumb Level Square/
PLS Inc.

Jared Rakisits
Mountain Country Homes

Scott Stubbs
Legacy Group
Construction

Dennis Loomis
Loomis Construction

Will Dator
WF Construction

Gary Hill
Midway Construction

Mike Mercer
Aerie Construction

Rich Williams
Williams Builders

Richard Jaffa
Jaffa Group Design/Build

M



MLD

Appliances | Plumbing | Hardware

MLD.COM

ELEVATE YOUR IMAGE™



ELEVATORS, WHEELCHAIR LIFTS, DUMBWAITERS

A+ Elevators & Lifts is a premier manufacturer of high-end custom home elevators, and provider of low-rise commercial elevators, wheelchair lifts, dumbwaiters, freight lifts and accessibility equipment. With it's corporate headquarters in Salt Lake City, Utah, it has local staff serving the Colorado, Idaho, Montana, Nevada, Utah and Wyoming regions. Holding various patents on elevator products and components, A+ Elevators strives to provide the most current technology, safest and highest quality products available. Offering sales, installation, service, maintenance and repair for both residential and commercial new construction, remodels and additions, A+ Elevators takes the "A+" approach, providing a level of customer service that is unmatched in the industry.



An **A+ Connection** Company

COLORADO | IDAHO | MONTANA | NEVADA | UTAH | WYOMING

888.444.2758 | apluselevators.com



Builders FirstSource and BMC have joined forces to create the premier supplier of building materials and services. By the end of 2021, all of our locations will take on the Builders FirstSource brand.

Let us help you with building your dream home. We offer top-quality products with our extensive selection of cabinets, windows, doors, millwork, lumber, trusses, designer hardware, siding and decking. With Builders FirstSource and BMC, you get the quality the pros trust with service you can count on.

Product specialists available for professional showroom consultations by appointment.



16 LOCATIONS SERVING THE SALT LAKE MARKET

- Heber City Lumber | 1690 South Hwy 40 | Heber City, UT 84032
- Layton UT Millwork | 1617 West Hillfield Road | Layton, UT 84041
- Layton UT Yard | 1617 West Hillfield Road | Layton, UT 84041
- Lindon UT Truss | 101 South Geneva Road | Lindon, UT 84042
- Midvale Lumber | 7380 South 700 West | Midvale, UT 84047
- Orem UT Millwork | 117 South 1600 West | Orem, UT 84058
- Orem UT Yard | 117 South 1600 West | Orem, UT 84058
- Park City UT Yard | 1185 West Lori Lane | Kamas, UT 84036
- Salt Lake City UT Millwork | 4711 West 1730 South | Salt Lake City, UT 84104
- Salt Lake City UT Truss | 609 South March Street | Salt Lake City, UT 84104
- Sandy UT Cabinets | 9666 South 500 West | Sandy, UT 84070
- Sandy UT Windows | 9666 South 500 West | Sandy, UT 84070
- Spanish Fork Lumber | 1350 North Main Street | Spanish Fork City, UT 84660
- West Haven UT Yard | 3159 South 1900 West | West Haven, UT 84401
- West Jordan UT Yard | 7902 South 1410 West | West Jordan, UT 84088
- West Valley UT Millwork | 1580 West 3860 South | West Valley, UT 84119

Visit us at **BLDR.com** or **BuildWithBMC.com**

FREQUENTLY ASKED QUESTIONS

1

Showcase Guidelines

- Do not enter a Showcase home if you are sick or do not feel safe.
- The Virtual Showcase is available online with your ticket purchase at www.PCShowcaseofHomes.com
- No bare feet. Please bring a clean pair of socks to wear, use the shoe covers provided, and follow the instructions from each builder.
- Be respectful of furniture and surfaces, do not touch anything.
- No food or drink is permitted in the homes at any time.
- Please watch your step.

2

Do you have any tips?

Wear comfortable, easy to remove shoes and clean socks.
Leave unnecessary items and bags in your vehicle.
Use hand sanitation stations at each home.
Take pictures and tag us! #PCShowcaseOfHomes.

3

How much does a ticket cost?

\$20.00 per ticket. Kids aged three (3) and older are required to have a ticket. Purchase at www.PCShowcaseofHomes.com. Please no strollers.

4

How many times can I walk through a home?

Your showcase ticket allows one entry into each of the showcase homes, with an additional 2 re-entries into a home or 2 of your choice. Tickets are good for all 7 days of the Showcase of Homes.

5

How and when can I access the Virtual Showcase?

The Virtual Showcase will be available on our website www.PCShowcaseofHomes.com August 26 - October 6, 2022. You will need to enter the passcode on your showcase ticket to access the virtual showcase.

6

How can I vote for People's Choice Award?

You can vote on the showcase website www.PCShowcaseofHomes.com. Enter your unique voting passcode found on your showcase ticket to access voting. Voting ends at noon on September 16, 2022.

7

Where can I get the Park City Showcase mobile app and why should I use it?

Search Park City Area Showcase of Homes in your app store to download the mobile app for home details, pictures, turn by turn directions and more.



WWW.PEPPERTREEKITCHEN.COM

CABINETS & DESIGN

**7940 S. 1300 W. WEST JORDAN, UT 84088
801-565-1654**

**485 W. BROADWAY JACKSON, WY 83001
801-565-1654**



BEAUTIFUL AND SPACIOUS FAMILY HOME IN PROMONTORY

9021 N Promontory Summit Drive
5 Beds | 6 Baths | 9,017 SqFt
Park City, Utah | **Offered at \$9,000,000**

Golf Membership Available! Enjoy incredible top of the mountain views from this spectacular four season home. Designed by 4C Design Group, and meticulously built by Douglas Knight this home is perfect for parties and family gatherings. The open floor plan of the main floor has panoramic ski mountain views with rich wood floors and ceiling beams, a stunning stone fireplace, and a kitchen any chef would love. For sunny days, there is amazing deck space overlooking the mountains, as well as a well-equipped outdoor kitchen. For a night in, there is an 800-bottle climate controlled wine room with tasting area, a family friendly game room, and a cozy theater. On colder days, you will be glad to have the radiant driveway, deck heaters and hot tub on the lower deck with heated concrete and a fireplace. Charming kids rooms and luxurious guest rooms make everyone feel at home. Furnishings are negotiable.



LISTING THE FINEST PROPERTIES IN PROMONTORY

We are putting the power of Engel and Völkers International brand exposure behind our local expertise. Call us for a confidential evaluation of your property. +1 435-647-6301

ENGEL & VÖLKERS®
KARIN WILSON



WHEN YOU'RE BUILDING TO THE **ZIP** CODE, IT'S A DIFFERENT WORLD ENTIRELY.

We make the right products to do the right job, the right way, the first time. No matter what the region or climate, you can count on ZIP System™ Building Enclosures to streamline the performance of your air, water and thermal barriers for structural assemblies. Is your project Built to the ZIP Code™? See why others have made the switch at ZIPSystem.com. #BuiltToTheZIPCode



ZIPsystem™
BUILDING ENCLOSURES



AVAILABLE TO TOUR DURING THE 2022 PARK CITY AREA SHOWCASE OF HOMES

EZRA LEE DESIGN+BUILD

3526 Westview Trail

(PROMONTORY) PARK CITY

Architecture that will stand the test of time. This home is a piece of art that is not defined by any one style or time period. All rooms are open concept suites, that are supported by beautiful living spaces, and deep wrap-around decks that offer expansive indoor/outdoor living. The clean Scandinavian lines are complimented by organic finishes creating a beautiful aesthetic that is INTENTIONALLY UNCONVENTIONAL.

Ezra Lee Design+Build is an innovative, full-service firm that offers Architecture, Construction, Interior Design, and Furniture + Decor.

**EZRA
LEE
DESIGN
+BUILD**



EZRA LEE DESIGN+BUILD

801.448.6876
info@ezralee.com
ezralee.com

Plan Designer: Ezra Lee Design+Build
Interior Designer: Ezra Lee Design+Build

PCAHBA MEMBER SUBCONTRACTORS AND SUPPLIERS

Blackburn Build	Masterpiece Trade Services
Dominion Energy	MLD – Mountain Land Design
Ezra Lee Design+Build	Rocky Mountain Waterproofing
Hearth & Home Distributors of Utah	Roth Living
Honey Bucket	Sunpro
Jones Mechanical	Velux Skylights
Ledyard Homes	



HOME IS NOT FOR SALE

HOME	DECK & PATIO	GARAGE	BEDROOMS	BATHROOMS	GARAGE BAYS
5,834	4,002	1,965	5	4 FULL 1 HALF	4

SCAN FOR DIRECTIONS

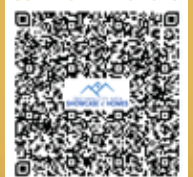





KILLOWEN CONSTRUCTION

7509 N. Bugle Trail

(PROMONTORY) PARK CITY



OUR WORK IS HONEST, AND OUR HOMES ARE FOREVER. The space you live in is important. It's an honor to be part of the team that builds a dream home into existence. We believe in working closely with architects, designers and our clients to create an atmosphere conducive to success.

Every project has challenges. No house is perfect. What matters is that those challenges are handled with transparency and high level problem solving.

We have curated a business model that lets us work with some of the best

subcontractors in the area. We are sure to communicate ahead of time what our expectations are and we are quick to ask them what they will need to meet those expectations. The hands that build your home are chosen by us, and we have made those relationships a high priority. Our goal is to smoothly take your dreams from concept to reality.

Kilowen specializes in full-build custom homes, as well as additions and remodels in Summit & Wasatch Counties and beyond.



TYLER FARRELL



DAVE GRINER

KILLOWEN CONSTRUCTION

385.204.4570
hello@killowenco.com
killowenco.com

Interior Design: Kimberly Parker Design

PCAHBA MEMBER SUBCONTRACTORS AND SUPPLIERS

Fireout LLC

MLD – Mountain Land Design

Hearth & Home Distributors

Midway Floor Coverings

Jones Mechanical Inc

Kimberly Parker Design

Ferguson Bath, Kitchen & Lighting Gallery

Tanner Glass & Hardware

Rocky Mountain Waterproofing

Epic Windows & Doors

Garage Force

Ratio Inc.

01

HOME IS NOT FOR SALE

PRICE
\$4 MIL +

TOTAL SQ. FT.
7,990

BEDROOMS
6

BATHROOMS
7 FULL 2 HALF

GARAGE BAYS
4

SCAN FOR DIRECTIONS



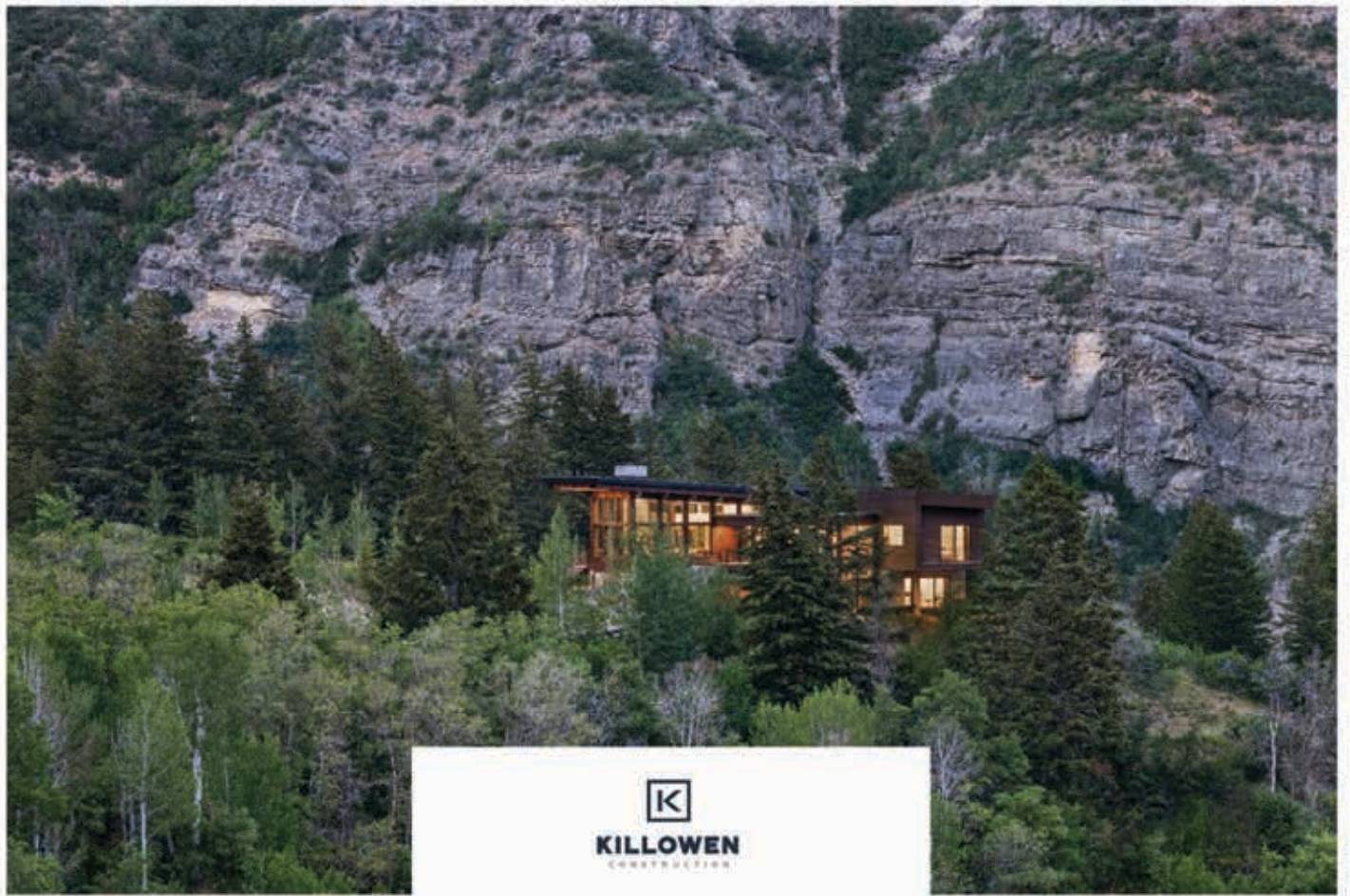

385.204.4570 | killowenco.com
[@killowenconstruction](https://www.instagram.com/killowenconstruction)





HAMLET HOMES

1242 Gambel Oak Way

(SILVER CREEK VILLAGE) PARK CITY



The Janis Floorplan, named after Janis Joplin, a famous Female Rock Artist, was created specifically with “amazing” in mind. When you are named after Janis Joplin — you expect legendary status and that is just what you get with this home. The Janis is also the Model Home for our Silver Creek Single-Family Home Community — which should tell you how amazing we think it is!

The home features a Two-Story Entry Way that draws you in right from the start. The stunning Kitchen includes a large pantry and lots of storage. It connects to a Living and Dining area that opens to an amazing outdoor living space so you can enjoy all that mountain living in Park City has to offer.

On the upper level, you will find a Rockin’ Owner’s Suite & Bathroom with a private Balcony to enjoy the fresh mountain air. With two Bedrooms, a Full Jack-and-Jill

Bathroom and an open Loft area, there is enough area for the whole band to rest their heads. A Laundry Room is also conveniently located on this level.

The completely finished lower level adds an additional two Bedrooms, Full Bath and “Rockstar” Family Room — perfect for entertaining all the badass people in this neighborhood.

The Janis was specifically designed for this community with both indoor and outdoor living in mind. Incredible views, lots of windows for natural light and a community full of amazing amenities - you are sure to love this one-of-a-kind rock-themed house that you will be proud to call your home!



Nate Kingdon, Phil Mosher, Tami Ostmark, Barry Gittleman, John Peterson, Jon Southern, Elliott Jenkins

HAMLET HOMES

801.736.1957
contactus@hamlethomes.com
hamlethomes.com

Interior Designer: Hamlet Homes Marketing & Design Team

PCAHA MEMBER SUBCONTRACTORS AND SUPPLIERS

Builders FirstSource
Hearth & Home Distributors of Utah
Hansen-All Seasons Insulation
Tanner Glass & Hardware

02
HOME IS NOT FOR SALE

TOTAL SQ. FT.
3,126

BEDROOMS
5

BATHROOMS
3 FULL 1 HALF

GARAGE BAYS
2





G R E A T

Homes.
People.
Experience.

Heber City • Park City • American Fork • The Jordanelle • So Salt Lake City

Coming Soon: Pleasant Grove • West Valley City • Wasatch County

www.hamlethomes.com



GREENLAW CONSTRUCTION

1458 W. Orion Way

(SKYRIDGE) HEBER CITY

Located on a corner lot in the SkyRidge Subdivision, this magnificent vacation home demands attention with 360-degree curb appeal. Thoughtfully designed and built by Greenlaw Construction, in a way where mountain modern design integrates both the exterior and interior spaces into one. This open concept home is complete with exaggerated roof lines, and a mix of natural materials including limestone, cedar, and metal accents. All of which blur the lines of indoor-outdoor living. The entry foyer will delight the eye with its grand stone wall, floating staircase, and chandelier that draws you upstairs to the main level. The main living area maximizes the incredible views inside and out. Enjoy the Jordanelle Reservoir

and the ski slopes of Deer Valley all within one space. The lower level is where guests will stay with 3 bedrooms and a rec room for entertaining.

Greenlaw Construction is a family-owned business with quality, experience, and teamwork in all the work they do. With their in-house design-build team, they make their client's dream homes a reality. They build custom homes that maximize views while creatively utilizing the unique lots to their full potential. Greenlaw Construction can build you a home that stands the test of time in craftsmanship and design.



KELLERT GREENLAW



ALEXA GREENLAW



HAYDEN GREENLAW

GREENLAW CONSTRUCTION

801.979.3645

info@greenlawconstruction.com
greenlawconstruction.com

Plan Designer: Greenlaw Construction
Interior Designer: Greenlaw Construction

PCAHBA MEMBER SUBCONTRACTORS AND SUPPLIERS

Arizona Tile	Rock Tops
Bedrosians Tile and Stone	ShadeCo
Builders FirstSource	Tanner Glass & Hardware
Dominion Energy	The Cabinet Gallery
Pick's Insulation	

03

HOME IS NOT FOR SALE

PRICE
\$2.8 MIL

TOTAL SQ. FT.
3,500

BEDROOMS
4

BATHROOMS
3 FULL 1 HALF

GARAGE BAYS
2





FROM DESIGN CONCEPT TO COMPLETION, WE
BUILD HOMES THAT STAND OUT



GREENLAW CONSTRUCTION
CUSTOM HOMES | DESIGN | BUILD



JC LUXURY HOMES

1522 W. Ursa Way

(SKYRIDGE) HEBER CITY



Situated in the beautiful SkyRidge community, JC Luxury Homes has created a gorgeous, mountain modern inspired downhill build, the StarryNight. This home truly captivates with its progressive exterior architecture combined with a contemporary, refined interior. Immediately entering the front door, the panoramic views are captured with floor to ceiling glass, providing maximum view corridors and large decks that wrap around, connecting the master suite and great room. Expansive glass doors open up to compliment an indoor/outdoor living experience and provide bigger spaces for relaxing and entertaining. Experience the signature 'glass cube' dining area as it gives the feeling of being suspended above the ground while taking in the sweeping views of the Jordanelle and Deer Valley. The interior is crafted with clean lines and every amount

of space is carefully planned and utilized to create open areas of living with high ceilings, as well as ample storage throughout the home. The StarryNight boasts carefully selected finishes and attention to detail in every area of the home such as the large chef's kitchen decked in the latest, top of the line Thermador appliances, butler's pantry, floor to ceiling stone encased fireplace, and glass wine room. The views continue downstairs from the retreat of the family room, large glass office and 3 additional on suite bedrooms. Make no mistake, this home is designed to live large and efficient. JC Luxury Homes has once again created and delivered an exceptional property with integrity, excellence, and a streamlined process of building and service that defines what luxury living is all about. Come see for yourself, the StarryNight is the home that dreams are made of.



DOUG JARDINE

JC LUXURY HOMES

435.602.4400

info@jardineconstruction.com
jardineconstruction.com

PCAHBA MEMBER SUBCONTRACTORS AND SUPPLIERS

Anvil Appliances/Anvil Cabinet & Mill

MLD – Mountain Land Design

Park City Blind & Design

BTM Construction LLC

Hearth & Home Distributors

Pick's Insulation

Builders FirstSource

RC Ornamental

Honey Bucket

Berkshire Hathaway HomeServices of Utah

Fiber-Seal of Utah (Fabric/Rug Treatment & Protection)

Silver Mountain Glass LLC

04

HOME IS NOT FOR SALE

PRICE
\$2-4 MILTOTAL SQ. FT.
3,200BEDROOMS
4BATHROOMS
4 FULL 1 HALFGARAGE BAYS
2

SCAN FOR DIRECTIONS





IMAGINATIVE ARCHITECTURE // CUTTING EDGE DESIGN
 INNOVATIVE TECHNOLOGY // IMMACULATE CRAFTSMANSHIP

A development with magnificent views, high-end features, and a seamless process that goes into every home. For more info, visit JCLuxuryHomesExperience.com



ÉTIENNE



The sunny side of Sundance! Introducing Provo Canyon's last developable lots, designed with luxury single-family and twin homes. For more info, visit EtienneAtDeerCreekMeadows.com

KAREN JARDINE REALTOR®
 (801) 645-9093 karen.jardine@bhhsutah.com

BETTINA LALLY REALTOR®
 (310) 403-6375 bettinalally@bhhsutah.com

BERKSHIRE HATHAWAY | Utah Properties
 HomeServices

©2022 BHH Affiliates, LLC. An independently owned and operated franchisee of BHH Affiliates, LLC. Berkshire Hathaway HomeServices and the Berkshire Hathaway HomeServices symbol are registered service marks of Columbia Insurance Company, a Berkshire Hathaway affiliate. Equal Housing Opportunity. Information not verified or guaranteed.



MAYFLOWER LUXURY HOMES

1461 W. Ursa Way

(SKYRIDGE) HEBER CITY

Mayflower Luxury Homes delivers the highest levels of quality craftsmanship and customer service. We have over two decades of experience and have built 600 single-family homes and 500,000 sq. ft. of commercial Space. One of our principals was a past President of the Utah Valley Home Builders Association and a Board Member of the National Home Builders Association.

Our unique concierge services are with you every step of the way. From assisting with furnishings and fixtures or left as an empty canvas to fill your own home, Mayflower Luxury Homes is here to provide the upmost satisfaction and exceed your homebuilding expectations.



DAVE LEWIS



CURTIS HANSEN

MAYFLOWER LUXURY HOMES

435.339.0737

dave@mayflowerluxuryhomes.com

mayflowerluxuryhomes.com

PCAHA MEMBER SUBCONTRACTORS AND SUPPLIERS

Ferguson Bath, Kitchen & Lighting Gallery

Lone Pine Cabinet

Masterpiece Trade Services

Pick's Insulation

Sunpro

On Top Roofing

Rocky Mountain Waterproofing

05

HOME IS NOT FOR SALE

PRICE
ASK FOR PRICING

TOTAL SQ. FT.
3,833

BEDROOMS
5

BATHROOMS
4 FULL 1 HALF

GARAGE BAYS
2

SCAN FOR DIRECTIONS





Building Custom &
Semi-Custom Homes in
Park City, Utah

MAYFLOWER
LUXURY HOMES

info@mayflowerluxuryhomes.com

mayflowerluxuryhomes.com

(435) 339-0737



H2 HOMES

485 W. Peace Tree Trail

(DEER VISTA) KAMAS



H2 Homes welcomes you to this exquisite, modern mountain estate. Meticulously designed with unparalleled craftsmanship, this home is one you won't want to miss. Located in beautiful Deer Vista, an incredible community overlooking Jordanelle Lake with a panoramic view of the Wasatch Front.

The exterior showcases an impressive Tesla Shingle Roof and rich, dark-stained timbers with barnwood siding, metal panels, and natural stone. The remarkable landscape design blends in beautifully with the surrounding native vegetation. All exterior concrete is equipped with snowmelt for a hassle-free winter.

Enter through the solid mahogany wood pivot door into this spacious floorplan that spans 6,289 square feet and features 5 bedrooms, 5 baths, and 2 half baths. Enjoy the warmth and comfort of the radiant heated flooring throughout the entire home. The great room boasts a 23' vaulted ceiling featuring white oak treatments and beams. A stunning floor-

to-ceiling fireplace completes the great room, along with a 15 ft multi-slide pocket door that frames the breathtaking views. Walk out onto the expansive deck that is perfect for entertaining and features a built-in bbq and 8' linear firepit. The gourmet kitchen flaunts a 10' waterfall island and custom floor-to-ceiling cabinets. A floating steel staircase will lead you to the lower level where you will find a hidden wine and gun room secured with a Fort Knox Vault Door hidden behind a secret bookcase door. The space under the suspended slab garage floor is fully utilized with a full-size gym and extra storage space.

At H2 Homes, we assist our clients with every aspect of home building, from the conceptual design to the finishing touches. We specialize in building custom homes tailored to the needs and budgets of each individual, focusing on relationships of trust and transparency. Our process has been tested and proven over years of experience and hundreds of successful builds, and together we can build something that you will be proud to call home.



JOEL HARRIS



LAYNE HARRIS



NATE MAUGHAN

H2 HOMES

801.424.6637
info@h2homes.com
h2homes.com

PCAHA MEMBER SUBCONTRACTORS AND SUPPLIERS

MLD – Mountain Land Design
BTM Construction LLC
Hearth & Home Distributors
Hansen-All Seasons Insulation
Honey Bucket
Pella Windows & Doors Mountain West

06
HOME IS NOT FOR SALE

PRICE
\$4 MIL +

TOTAL SQ. FT.
6,290

BEDROOMS
5

BATHROOMS
5 FULL 2 HALF

GARAGE BAYS
3

SCAN FOR DIRECTIONS





Utah's Fireplace and Stone Experts!

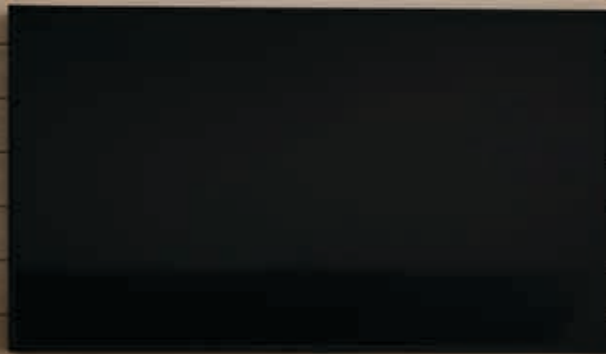

VISIT OUR SHOWROOM AT
1678 N STATE STREET OREM

801-224-5550

WWW.HHDU.COM





GOUGH CONTRACTING

186 W. Lazy Acres Lane

(LAZY ACRES ESTATES) KAMAS

The integration of modern luxury and old-world charm. This home is settled in the lush valley of a long-established ranch land. Unobstructed southern views of Mt. Timpanogos and northern views of the Uintah Mountain range are always visible. This modern-English dwelling features a spectacular masonry fireplace, dining wall, and range hood as the focal point of the primary living space. The Lazy Acres Estate is designed with timeless finishes and intricate details.

This home was intended for gathering. That is why you will find a jaw-dropping outdoor entertainment space. The recessed sand-washed firepit can sit a party of more than twenty people with room for eight in the adjacent spa. The outdoor kitchen and dining area are also found on the gorgeous decorative concrete patio.

Full smart home integration from the blinds to the sound system to the firepit. This home can be controlled from your phone to set any mood. Picture the perfect morning routine...the blinds in the luxurious Primary bedroom rise automatically with the sun. In the spa like bathroom the steam shower starts releasing the relaxing scent of eucalyptus, and the aroma of fresh coffee fills the air as the Wolf coffee system creates the perfect latte. The feeling of pure bliss. That is precisely what we have created in this home.



WAYNE GOUGH



DEWAYNE GOUGH

GOUGH CONTRACTING

435.640.8343

info@goughcontracting.com

GoughContracting.com

Interior Designer: Jana Gough Design

PCAHBA MEMBER SUBCONTRACTORS AND SUPPLIERS

Silver Mountain Glass LLC

MLD – Mountain Land Design

Jana Gough Design

Sunpro

Ferguson Bath, Kitchen & Lighting Gallery

Arizona Tile

Bedrosians Tile and Stone

Sierra Pacific Windows

07
HOME IS FOR SALE

PRICE
ASK FOR PRICING

TOTAL SQ. FT.
5,027

BEDROOMS
4

BATHROOMS
4 FULL 1 HALF

GARAGE BAYS
3

SCAN FOR DIRECTIONS





CUSTOM HOMES



GOUGH
CONTRACTING

Gough Contracting incorporates Old World craftsmanship with new world techniques on every custom home. Our name has become established throughout Park City, Utah and the Wasatch Back with each project we've completed. Being meticulous and creative artisans is what we are known for and that is what we strive to bring in building custom one-of-a-kind homes.

Our relationships with our clients and skilled craftsmen are built on trust, integrity, collaboration, and positive experiences.

Our design-build team ensures that the planning, design, and construction phases of your project will flow seamlessly as we curate your home with superior quality from the floorplan to the finishing touches. Our team will produce a home that is both functional and beautiful according to your vision.



IG: @gough_contracting

(435) 640 8343

www.goughcontracting.com

**JOE WITT CONSTRUCTION****339 E. Deer Ridge Drive**

(DEER RIDGE ESTATES) MIDWAY

We work for good people." This has become the motto for Joe Witt Construction and most of our clients quickly become our lifelong friends. Building high-end custom homes for exceptional people is our specialty and usually, after a great working relationship is established, we can be talked into building barns, workshops, arenas, and anything else our client's desire.

Our roots run deep, and this all starts with the local owner of the company, Joe Witt. Joe was raised in the shadow of the Wasatch mountains and grew up in the trenches

of the construction industry. His lifelong connections, knowledge, and relationships along with those of his team, give his clients the upper hand when building in Wasatch or Summit Counties.

We hope you enjoy this beautiful home and look forward to making your building dreams a reality.



JOE WITT

JOE WITT CONSTRUCTION

801.979.9000

joewittconstruction@msn.com

joewittconstruction.com

Plan Designer: Curtis Design Group**Interior Designer:** Mary Lauritzen, Joe Witt Construction**PCAHBA MEMBER SUBCONTRACTORS AND SUPPLIERS**

Curtis Design Group

08
HOME IS FOR SALEPRICE
\$4 MILTOTAL SQ. FT.
6,038BEDROOMS
5BATHROOMS
4 FULL 1 HALFGARAGE BAYS
4

SCAN FOR DIRECTIONS



Welcome Home

JOE WITT
CONSTRUCTION
GENERAL CONTRACTOR
801-979-9000

Trusted Partners





ELEMENTS CUSTOM HOMES

1129 W. Lime Canyon Way

(LIME CANYON) MIDWAY



This beautiful farmhouse, built on a 30-acre Estate is tucked in the lush mountains of Midway. This home was built and planned for family gatherings, and outdoor flow, with a barn used to accommodate for those extra important occasions, a private mile-long hiking trail just steps away from the backdoor, with great views from your deck overlooking your gentleman's farm and the rest of the valley. The home features an intentional use of space making it feel less like a house

and more like a home. At Elements Custom Homes we pride ourselves on making your house feel more like a home. For us, the home is not one of life's 3 necessities, but can be one of the most important and sacred places on this earth. We feel honored and blessed to be able to build the place where people raise their family, live their future, and build their dreams. For questions about our building and planning services contact Driggs Walker at 435-513-1776.



DRIGGS WALKER

ELEMENTS CUSTOM HOMES

435.513.1776
elementscustomhomes@gmail.com
builtbyelements.net

Interior Designer: Inspirations Design Studio

PCAHBA MEMBER SUBCONTRACTORS AND SUPPLIERS

Inspirations Design Studio

09

HOME IS NOT FOR SALE

PRICE
ASK FOR PRICING

TOTAL SQ. FT.
4,842

BEDROOMS
4

BATHROOMS
3 FULL 1 HALF

GARAGE BAYS
4





Beautiful outdoor living built for life.®

Concordia Symmetry Cinnabar Decking and HavenView CountrySide Tranquil White Railing

You love the outdoors. And your beautiful new deck will be a living space that integrates your home seamlessly with the natural environment.

We share this same passion. And when you're choosing your decking, we want you to know that you're choosing a product that is both good for your home and for the environment. Learn more at fiberondecking.com.

Wood



Trees are beautiful.

We're saving more than 1 million trees from being cut down every year.

Plastic



Plastics last a lifetime. Or ten.

100 million pounds of recycled plastic put to good use every year.

Water



Resourceful to the last drop.

Manufacturing composite decking requires a constant source of water. The good news is, we reuse almost all of it.

Waste



Don't waste a thing.

We reuse 98.5% of the waste from our manufacturing process.

distributed by





IVORY HOMES

427 South 1850 East

(BEAUFONTAINE) HEBER CITY



From the inside out the Oakmont exudes luxury and space. All the rooms in this beautiful rambler make a statement with the help of high ceilings and large windows. The main floor of the Oakmont features a large kitchen open to the bright nook and living space, a formal dining room, study, mudroom, laundry

room, and a stunning master bedroom and bathroom. Downstairs you have the option to finish as many as four bedrooms in addition to the large family room and storage space. The classic design of the Oakmont will never go out of style.



NEENA BEVERLY

IVORY HOMES

801.747.7000

neenab@ivoryhomes.com

ivoryhomes.com

Plan Designer: Ivory Homes – Brian Apsley
Interior Designer: Ivory Homes Design Team

PCAHA MEMBER SUBCONTRACTORS AND SUPPLIERS

MLD – Mountain Land Design Hearth & Home Distributors
Hansen-All Seasons Insulation Arizona Tile
Builders FirstSource

10
HOME IS NOT FOR SALE

PRICE
\$1.6 MIL

TOTAL SQ. FT.
5,462

BEDROOMS
5

BATHROOMS
3 FULL

GARAGE BAYS
3





Park City, Francis, and Heber

7 AMAZING LOCATIONS IN THE WASATCH BACK

visit www.ivoryhomes.com to learn more





Come see
why we do more
Parade of Homes
installations than
any fabricator
in UTAH!



Creative Granite & Design is where
Mother Earth's masterpieces and
skilled craftsmanship meet to create
an exquisite countertop, that will
reflect and define your individual style.

REQUEST A QUOTE TODAY!
creativegranite.com | 801-886-0204



PUREHAVEN | **HOMES**

390 North Main Street
Heber City, UT 84032

801-870-6559

purehavenhomes.com



ELEVATED LIVING

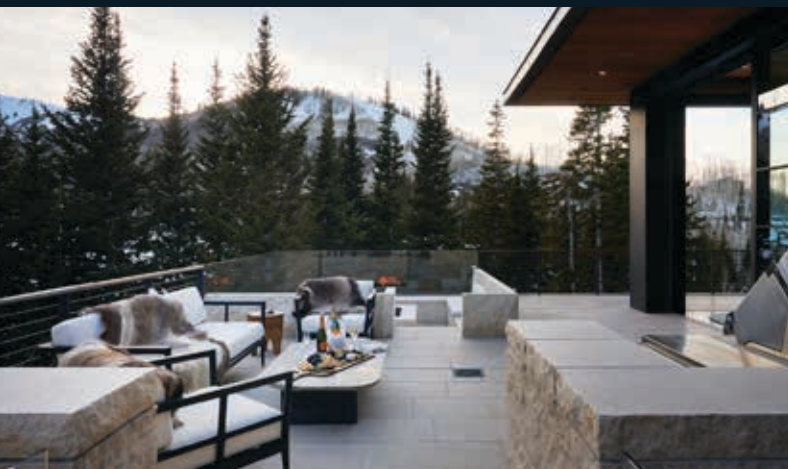

 **Magleby**
CONSTRUCTION

info@maglebyconstruction.com • maglebyconstruction.com
(801) 785-9998



CURTIS

DESIGN GROUP
RESIDENTIAL DESIGN



CURTISDESIGNGROUP.COM
385-999-5655

COMPLETE YOUR *Dream Home* WITH BLINDMAN WINDOW COVERINGS



Whether you are building new or renovating - your home can be a reflection of yourself, your personality, your dream! At The Blindman we understand what you want and are ready to help you with the finishing touches that will make your dream home become reality.



CALL OR TEXT US FOR A FREE IN-HOME CONSULTATION

SERVING THE ENTIRE WASATCH FRONT & ST. GEORGE

Lindon - Factory Showroom - 750 North 2800 West



CALL TEXT 801 692-2490

St. George - Showroom - 314 North 3050 East, Unit C



CALL TEXT 435 652-9947



FRESH FURNISHINGS START WITH



Fiber-Seal protects, cleans and maintains the soft surfaces in your home, allowing you to enjoy your furnishings without fear of spills and soils. We offer a complimentary spot cleaning service for protected items, so you can relax knowing Fiber-Seal has you covered!



FIBER-SEAL OF UTAH

(801) 577-8037 • Utah@FiberSeal.com • Utah.FiberSeal.com





All Types of Metal Roofing • Asphalt Shingles • Exterior & Interior Wall Panels • Gutter & Heat Cable
Architectural Sheet Metal • Snow Retention Systems • Hot Fluid Applied Waterproofing • Flat Roofs

Protecting Park City Homes for 22 Years & Counting

Schedule A Consultation: 435-615-8669

ontoproofing.com



THE **ULTIMATE** TEMPUR-PEDIC® SLEEP EXPERIENCE



Mention
this ad for
\$300
in Free sleep
accessories



The TEMPUR-LuxeAdapt™ Series takes Tempur-Pedic® to the next level. Made with our revolutionary TEMPUR-APR+® material, LuxeAdapt provides the ultimate in body-conforming comfort and relaxation.

Park City
MATTRESS



INTELLiBed
w/ GEL MATRIX III



**STEARNS
& FOSTER®**



1673 Ute Blvd, Suite D, Park City, UT 84098 | parkcitymattress.com

**BUDGET®
BLINDS**

Style and service for every budget.®

Same Great Service. Added Peace of Mind.

The well-being and safety of our customers is always our top priority. We're continuing to follow all guidelines and updates suggested by the CDC and local departments of public health. We are here to help you with your next home renovation project via free consultation. We value the local communities that we've been privileged to serve and are here to help when you're ready.

Request a **FREE** Consultation today
and learn more or visit our Showroom
next to the Smith's in Heber

435-417-6688

**enlightened
style™**
The Smart Choice for Your Windows.
EXCLUSIVELY BUDGET BLINDS



Portraits *that* Define *your* Lifestyle



A Portrait shows your Children
They are part of something Bigger

Impact
Photography



Scan code for
complimentary portrait session
and 20% off your
purchase up to \$500

THE LAND



redledges.com | 877.733.5334



THE LUXURY

Home is tranquil, serenely tucked within the magnificent Rocky Mountains, minutes from Park City and Deer Valley Resort in Utah. Home is exhilarating outdoor adventures inspired by the possibility of each season. Home is a legacy built on a deep-rooted desire to share the authentic beauty of land passed down through generations – seamlessly intertwining unparalleled luxury and endless comforts. Home is togetherness. Home is where your legacy begins.

HOME IS RED LEDGES. WELCOME HOME.

THE LEGACY

CUSTOM RESIDENCES AND HOMESITES | \$1.2 - \$10M+

WELLNESS | SKI | GOLF | TENNIS | DINING | EQUESTRIAN

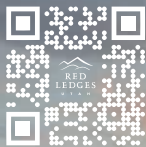

Berkshire Hathaway | Utah Properties Disclaimer: Obtain the Property Report required by Federal law and read it before signing anything. No Federal agency has judged the merits or value, if any, of this property. All recreational facilities are privately owned and operated as a club with mandatory membership fees. This does not constitute an offer to sell or a solicitation of an offer to buy in Ohio or in any other jurisdiction in which registration or any other legal requirements have not been fulfilled. ©2022 Red Ledges Land Development, Inc. ©2022 BHH Affiliates, LLC. An Independently owned and operated franchise of BHH Affiliates, LLC. Berkshire Hathaway HomeServices and the Berkshire Hathaway HomeServices symbol are registered service marks of Columbia Insurance Company, a Berkshire Hathaway affiliate. Equal Housing Opportunity.

AVAILABLE FOR PURCHASE

360 SOUTH OLD STONE ROAD
HEBER CITY, UT



UNDER CONSTRUCTION. TO BE COMPLETED 2023. ORGANIC MODERN DESIGN. 10,221 SQUARE FEET.
SEVEN BEDROOMS. EIGHT BATHROOMS. TWO KITCHENS. THEATER ROOM. GYM.
FULLY LANDSCAPED. THREE CAR GARAGE. FULLY FURNISHED + DESIGNED, INCLUDES ALL FURNITURE.
CONTACT DYLAN CHATWIN - 801.494.4993



C | H
CHATWIN HOMES

CHATWINHOMES.COM

THE LIFESTYLE
COLLECTIVE

THELIFESTYLECOLLECTIVE.US



Let Alpine Fireplaces

FIRE UP

Your Indoor & Outdoor Living Spaces



Fireplaces &
Fire Features for your new
home & remodeling
projects!



Visit our showrooms to see
our exciting options for
your Indoor and Outdoor
Living Spaces and see full
burning displays!

BOISE

111 South Stratford Drive
208-246-8858

SUGARHOUSE

2236 South 1150 East
801-487-4446

SANDY

9192 South 300 West
801-566-0666

LEHI

782 West State Street
801-768-8411

OREM

1417 South State Street
801-225-4015

ST. GEORGE

393 East Riverside Drive
435-628-9133



www.alpinefireplaces.com

GET A FREE QUOTE

800-550-0952

Wood | Gas | Pellet | Electric | Gas Logs | Outdoor Fire Pits

Be bold, show off your **Style**, make your home a **Masterpiece** with **Studio Amsco Windows**, now available in **black non-painted capstock**

www.amscowindows.com

BEFORE



photos by @houslarsbuilt

AFTER



Utah's own since 1949



Huetter

MILL AND CABINET
SHOWROOM

4730 South 500 West • Murray, Utah 84123

801-266-3222 • www.huettermill.com

**Huetter Molding,
Stair Parts, and Installation**
FOR REMODEL AND NEW HOME CONSTRUCTION